

CCTvenues

— DOCKLANDS —

Experts in Event Space

cctvenues.co.uk

CCT Venues-Docklands

Experts in Event Space

With waterfront views, a private outdoor terrace and stylish interior design that's full of character, the newly refurbished CCT Venues-Docklands brings a breath of fresh air to a fast-changing area of London.

Re-opened after renovation in May 2018, our spacious Docklands property is equipped with an inviting exhibition area with private lounge, a large conference suite, fourteen individually air conditioned meeting rooms in a range of sizes, and a stylish restaurant run with passion by our award-winning in-house chefs.

Features include digital wall art, bespoke fixtures and fittings, and expansive views of the water from floor-to-ceiling windows, providing businesses across the capital with the perfect alternative to uninspiring hotel conference rooms and typically bland meeting spaces.

The site also has high-speed technology and excellent AV facilities – and technical support will be available throughout your visit should you need it.

This flexible venue can perfectly accommodate up to 250 delegates, making it the ideal choice for exhibitions, conferences and events, as well as smaller meetings.

Rooms	Size	Minimum numbers	Maximum Theatre style	Maximum Classroom style	Maximum Cabaret style tables of 8	Maximum Banqueting style tables of 10	Maximum U Shape style	Maximum Board style	Exam Style	Maximum Stand-up Reception
Sugar 1/2/3	22.5 x 7.7m	100	250	120	120	200	62	62	110	-
Sugar 1/2	16.4 x 7.7m	68	200	80	96	140	44	44	-	-
Sugar 2/3	13.0 x 7.7m	64	120	64	64	100	40	40	-	-
Sugar 1	10.4 x 7.7m	36	120	48	64	100	32	32	-	-
Sugar 2	6.1 x 7.7m	32	60	32	32	50	20	20	-	-
Sugar 3	6.1 x 7.7m	32	60	32	32	50	20	20	-	-
Jasmine	13.5 x 8.1m	60	150	62	72	100	32	32	-	-
Madeira	15.3 x 7.3m	35	120	56	64	80	32	40	-	-
Totara	7.9 x 6.2m	20	60	24	32	50	22	18	-	-
Juniper	7.3 x 6.8m	25	60	32	40	50	22	18	-	-
Teak	7.3 x 6.2m	18	60	24	32	-	16	16	-	-
Earl Grey	5.9 x 4.2m	10	20	12	16	-	14	14	-	-
Gold	4.0 x 4.0m	8	-	10	-	-	-	8	-	-
Silver	4.0 x 4.0m	8	-	10	-	-	-	8	-	-
Rum	4.0 x 4.0m	8	-	10	-	-	-	8	-	-
Aniseed	4.0 x 4.0m	8	-	10	-	-	-	8	-	-
Clove	3.7 x 2.6m	4	-	4	-	-	-	4	-	-
Sugar Lounge	15.0 x 7.5m	-	-	-	-	-	-	-	-	75
Restaurant	12.5 x 7.2m	-	-	-	-	-	-	-	-	75

Ceiling height: 2.57m



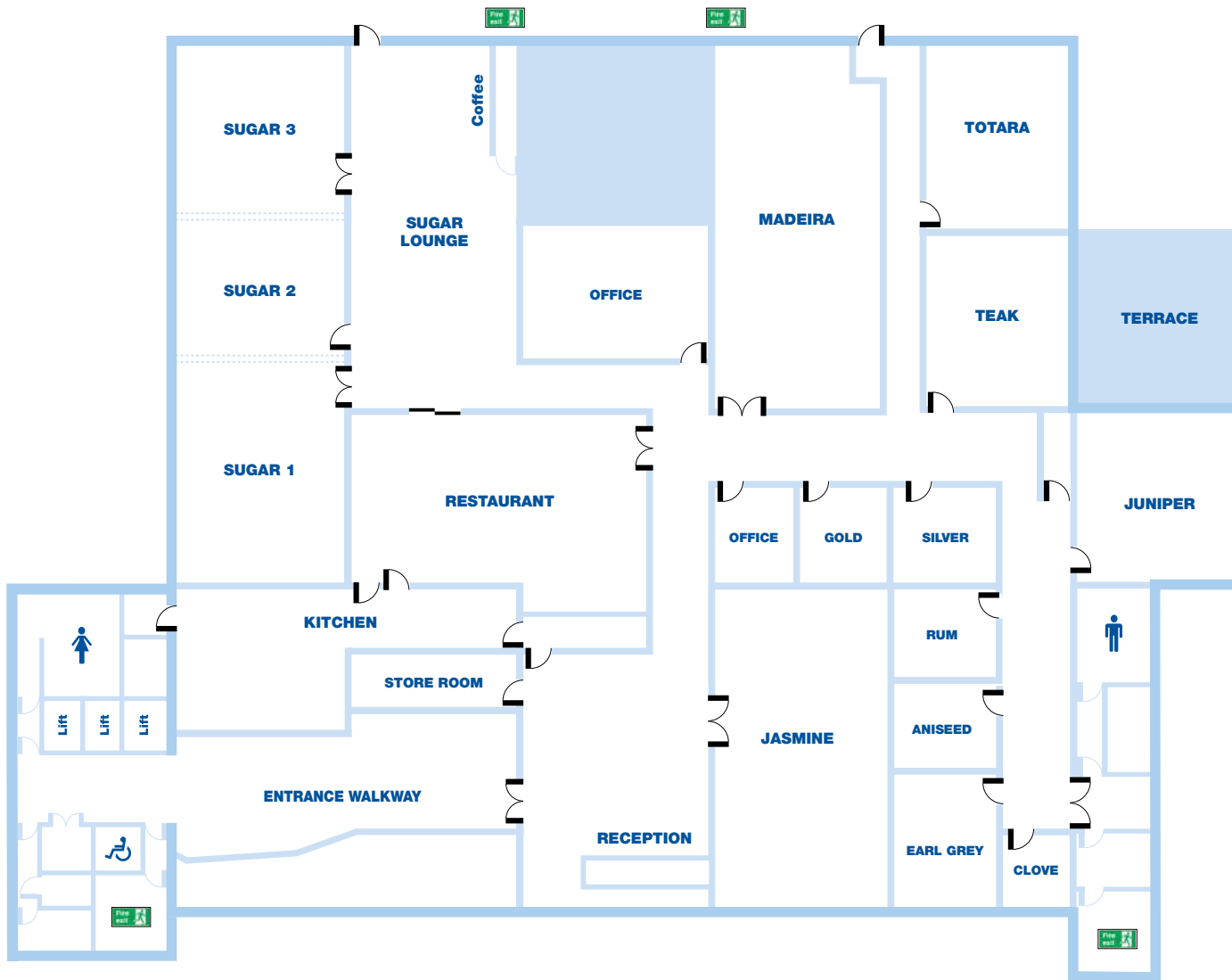



JZA Photography

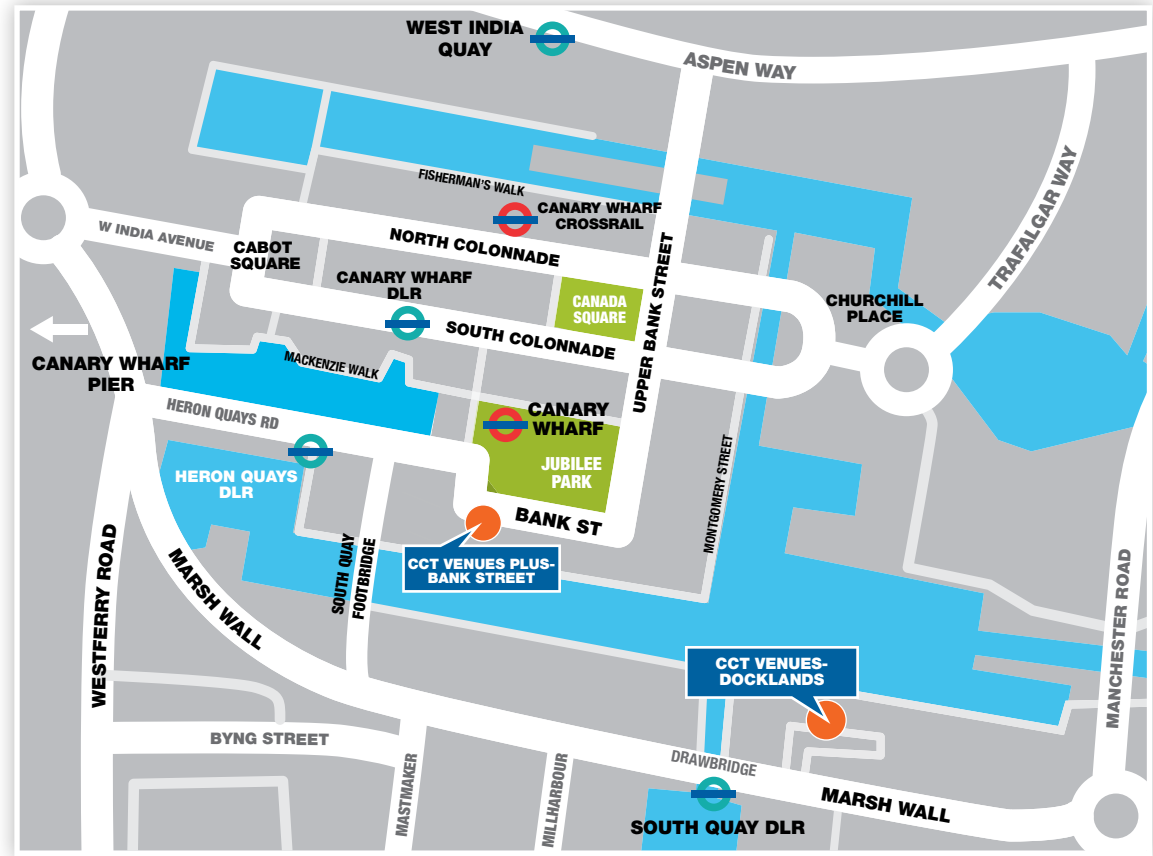

CCT Venues-Docklands

Thames Quay, 193 Marsh Wall, London, E14 9SG

For booking and enquiries:

T: 0808 168 1168

E: enquire@cctvenues.co.uk



cctvenues.co.uk



Central City Training Venues Ltd
Registered office: Two East Poultry Avenue, Smithfield, London, EC1A 9PT
Company Reg No. 5237921