



Experts in Event Space

[cctvenues.co.uk](http://cctvenues.co.uk)

## CCT Venues-Barbican Experts in Event Space

Refurbished and modernised in 2016, CCT Venues-Barbican offers a professional environment in a superbly convenient City location. The venue occupies the whole of Aldersgate House, on the corner of Aldersgate Street and Long Lane, in London EC1. The 20 training and meeting rooms are arranged over five floors and offer a range of bright, airy spaces, with large windows and individually controlled air conditioning.

CCT Venues-Barbican has a great mix of room sizes, with capacity for groups of 4 to 200. The venue has a strong reputation for superb service and expert management of training events.

In addition to great rooms, the venue also has a modern top floor Sun Restaurant, with capacity for over 140 and offering a range of freshly prepared food from our in-house chefs. All other floors have refreshment areas with tea and coffee facilities.

All rooms are well equipped with modern furniture, quality audio visual equipment and powerful data links. Events are supported by our first class, highly experienced team who put warm, professional service central to everything.

You'll find the venue directly next to Barbican underground station and only a few minutes' walk from CCT Venues-Farringdon and CCT Venues-Smithfield. City Thameslink mainline, Farringdon, St Paul's and Moorgate tube stations are also just a short walk away.

CCT Venues also have locations in Canary Wharf, offering great choice across London's busiest business districts.

Rooms	Size and location	Minimum numbers	Maximum Theatre style		Maximum Classroom style		Maximum Round Cabaret style (tables of 6)		Maximum Square Cabaret style (tables of 6)		Maximum U Shape style		Maximum Board style
			Portrait	Landscape	Portrait	Landscape	Portrait	Landscape	Portrait	Landscape	Portrait	Landscape	
Jupiter/Saturn	15.2m x 7.8m Third Floor	48	115	-	66	-	60	-	48	-	42	-	48
Jupiter	5.1m x 7.8m Third Floor	16	40	-	28	-	24	-	18	-	18	-	22
Saturn	10.1m x 7.8m Third Floor	35	70	-	46	-	36	-	30	-	28	-	36
Neptune/Pluto	18.6m x 5.8m Third Floor	44	100	-	78	-	66	-	54	-	52	-	56
Neptune	14.5m x 5.8m Third Floor	35	80	-	62	-	54	-	42	-	40	-	44
Pluto	4.1m x 5.8m Third Floor	8	18	-	12	-	12	-	-	-	10	-	12
Discovery/Apollo/Voyager Suite	25.0m x 7.8m Second Floor	90	185	200	112	116	114	96	78	90	68	44	74
Discovery/Voyager	20.1m x 7.8m Second Floor	70	135	150	84	84	90	78	66	72	52	36	56
Apollo/Voyager	9.8m x 7.8m Second Floor	30	70	70	40	46	36	36	30	36	26	22	32
Discovery	14.8m x 7.8m Second Floor	46	110	120	64	70	60	66	48	54	40	30	44
Apollo	4.9m x 7.8m Second Floor	16	40	-	28	-	24	-	18	-	18	-	22
Voyager	4.9m x 7.8m Second Floor	16	40	-	28	-	24	-	18	-	18	-	22
Xena	12.4m x 7.8m Ground Floor	40	90	-	66	-	54	-	42	-	34	-	40
Atlantis	9.5m x 5.8m Second Floor	24	64	-	40	-	36	-	36	-	24	-	30
Polaris	9.5m x 5.6m First Floor	20	56	-	30	-	30	-	24	-	20	-	24
Electra	8.0m x 6.3m First Floor	20	50	-	30	-	30	-	24	-	22	-	24
Uranus	7.8m x 5.1m Third Floor	16	40	-	28	-	24	-	18	-	18	-	22
Venus	7.6m x 4.6m Fourth Floor	14	40	-	24	-	24	-	18	-	16	-	20
Eris	5.7m x 5.7m First Floor	10	24	-	16	-	15	-	12	-	14	-	16
Regulas	6.3m x 4.8m First Floor	10	20	-	12	-	12	-	12	-	12	-	12
Luna	5.8m x 4.9m Second Floor	8	20	-	14	-	18	-	12	-	12	-	16
Earth	5.4m x 4.9m Fourth Floor	10	20	-	14	-	18	-	12	-	12	-	16
Mars	5.4m x 4.9m Fourth Floor	10	20	-	14	-	18	-	12	-	12	-	16
Vega	5.1m x 5.1m First Floor	8	20	-	12	-	12	-	-	-	12	-	12
Rana	5.1m x 5.1m First Floor	8	16	-	10	-	-	-	-	-	6	-	8
Sun Restaurant Standing capacity - 150	118m <sup>2</sup> Fourth floor	-	-	-	-	-	-	-	-	-	-	-	-

Ceiling height: 2.54m

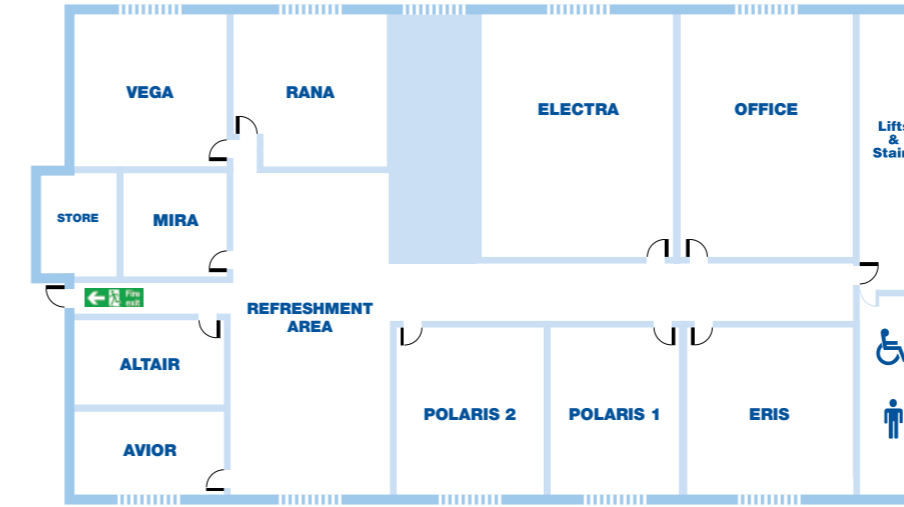

First Floor

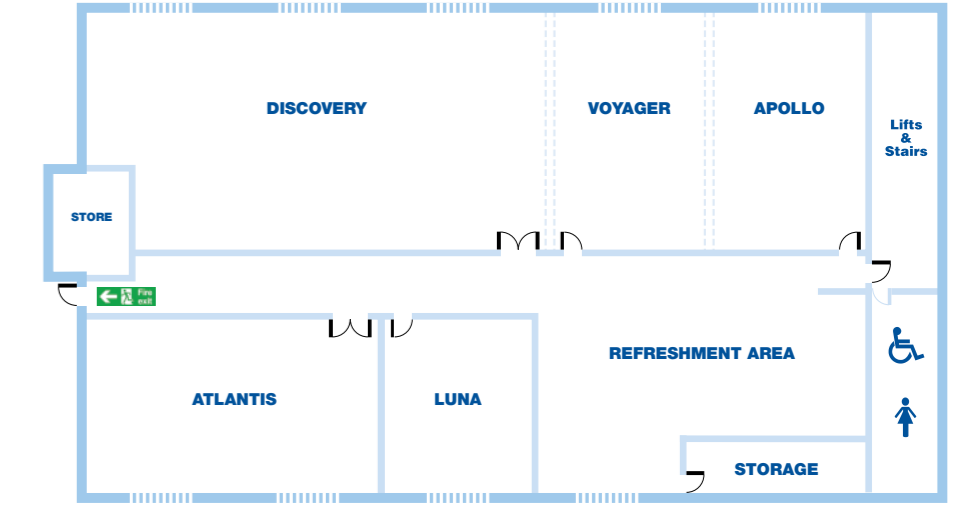

Second Floor

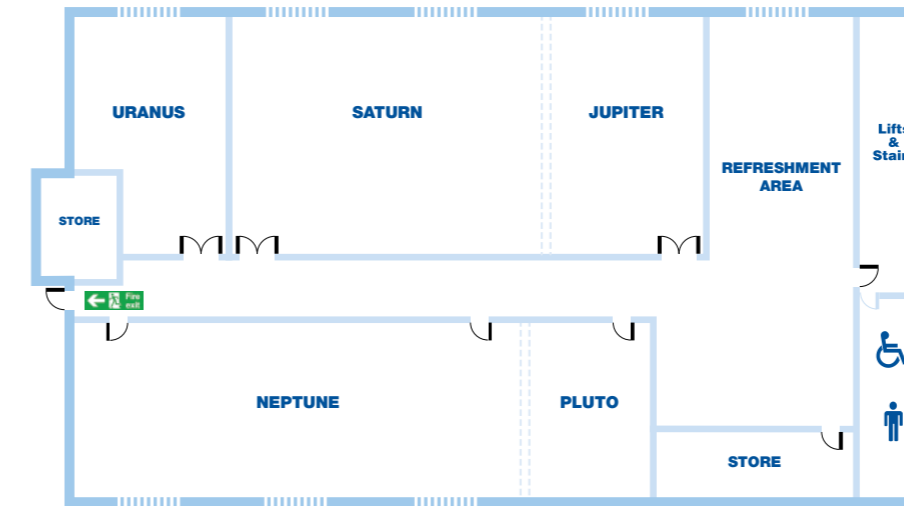

Third Floor

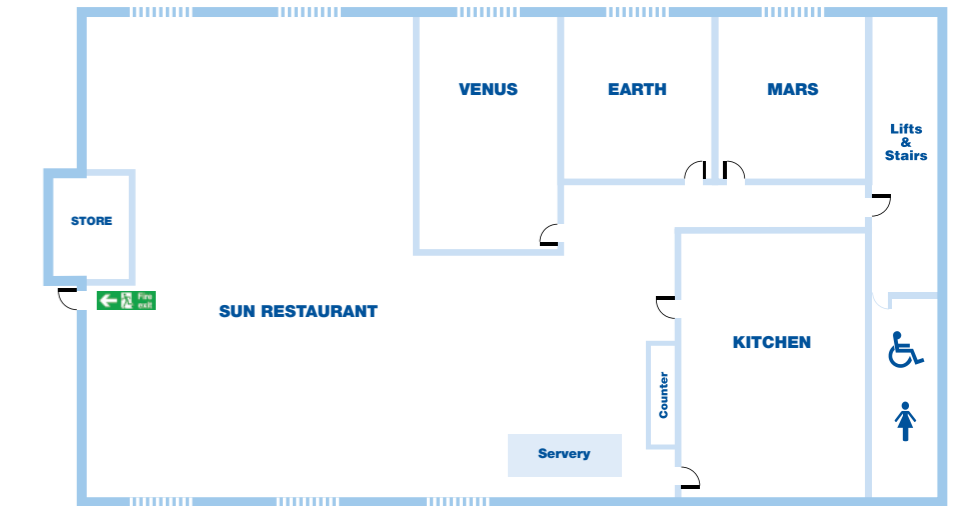

Fourth Floor

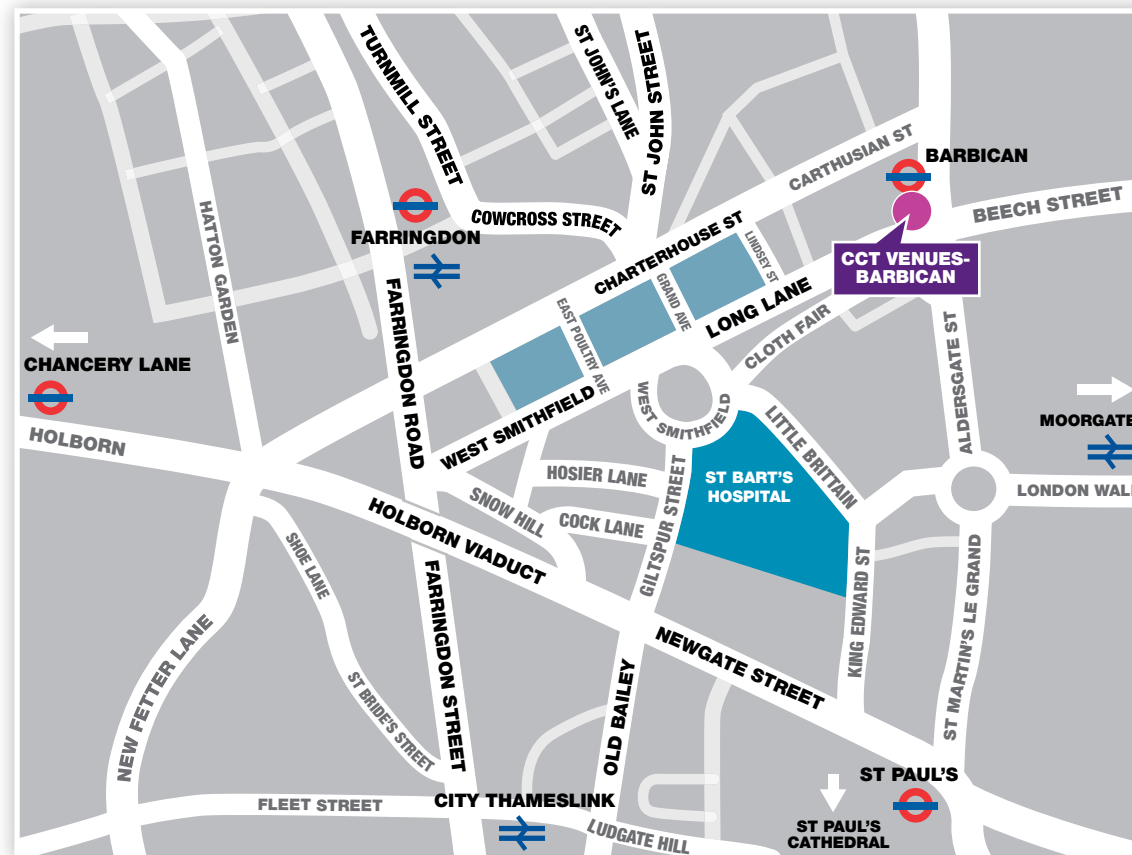

### CCT Venues-Barbican

Aldersgate House, 135-137 Aldersgate Street, London, EC1A 4JA

For booking and enquiries:

**T: 0808 168 1168**

**E: [enquire@cctvenues.co.uk](mailto:enquire@cctvenues.co.uk)**



[cctvenues.co.uk](http://cctvenues.co.uk)



Central City Training Venues Ltd  
Registered office: Two East Poultry Avenue, Smithfield, London, EC1A 9PT  
Company Reg No. 5237921



*“Thank you so much for the wonderful organisation of our meeting. Everything was very smooth and we were all really impressed with the venue, facilities and food. The team took the stress out of the entire process.”*

*London Council*

*“I am very happy with CCT Venues’ whole service, which has been very friendly, helpful, efficient and easy to deal with. I would definitely recommend holding meetings here - everything ran smoothly and we were well looked after at the Barbican venue - there was a lovely choice of good food too!”*

*National Broadcaster*



CCT Venues-Barbican, a professional environment  
in a convenient City location

